

# Tree Inventory & Arborist Report

**Prepared for:**  
Lev Living

**Subject Site:**  
1 Rosetta St, Georgetown, ON L7G 3P1  
**PART 2**  
**ST. MICHAELS STREET ROAD EXTENTION**

**Prepared By:**  
**The Urban Arborist Inc.**  
PO BOX #74525 Humbertown Centre  
Etobicoke Ontario M9A 5E2  
Tel: 416.833.6467  
[info@theurbanarborist.ca](mailto:info@theurbanarborist.ca)



---

**ISA Certified Arborist----Robert Rafal Lis----Cert. #ON-1374A**

**September 27 2024**

## Table of Contents

<b>1.0</b>	<b>Introduction.....</b>	<b>02</b>
1.1	Assignment .....	02
1.2	Existing Site Characteristics .....	02
<b>2.0</b>	<b>Methodology and Guidance.....</b>	<b>03</b>
2.1	Field Study .....	03
2.2	Tree Locations .....	03
2.3	Tree Conditions .....	03
<b>3.0</b>	<b>Tree Inventory .....</b>	<b>04</b>
3.1	Trees to Preserve .....	04
3.2	Trees to Remove .....	05
3.3	Trees to Injure .....	05
3.4	Trees to Plant .....	06
<b>4.0</b>	<b>Tree Preservation, Protection and Management .....</b>	<b>06</b>
4.1	Tree Protection .....	06
4.2	Tree Protection Barriers.....	06
<b>5.0</b>	<b>Conclusions and Recommendations .....</b>	<b>07</b>
Appendix 1	Tree Inventory.....	08
Appendix 2	Site Plan / Tree Inventory Plan Drawing TP-1.....	09
Appendix 3	Photographs .....	10-

## ***1.0 Introduction***

### *1.1 Purpose of Assignment*

The Urban Arborist Inc was retained by Lev Living to prepare a Tree Inventory & Arborist Report for a re-development project. The project consists of re-developing the existing site to build a 10, 12, and 14 storey condominium complex. There is a future road extension of St. Michaels Street that is addressed in this Arborist Report as a separate plan.



Figure 1. Aerial view of 1 Rosetta St, Georgetown, ON L7G 3P1

### *1.2 Existing Site Characteristics*

The subject site has many adjacent residential lands, adjacent Go Train parking, and Go Train Station. The grade of the property does not change throughout the property. The future road extension goes through a wooded area that has grade changes throughout with neighbouring residential properties bordering the R.O.W.

## 2.0 *Methodology and Guidance*

All data used in this report is empirical in nature, unless stated otherwise. All measurements in this report utilize the metric system of measurement.

### 2.1 *Field Study*

Site inspection and data collection was initiated August 8, 2024. All trees 10cm in diameter (DBH) and greater measured at 1.4m from grade (DBH) on the property and all trees within 6m of the subject site have been included in this report. Smaller than 10cm DBH have been captured and shown in the Tree Inventory Table in the notes.

### 2.2 *Tree Locations*

The locations of all trees 10cm DBH and greater were surveyed by J.D. Barnes with a completion date of August 24<sup>th</sup>, 2024. All surveyed trees were plotted and used for reference on the Tree Inventory Plan and shown on Tree Inventory Plan drawing TP-1 in appendix 3.

### 2.3 *Tree Conditions*

During field study a generalized assessment system was used to give each significant tree a rating based on structural condition and health condition.

The following 5 level assessment for health is listed below.

- Very Poor - Tree displays severe dieback of branches, canopy is extremely sparse. May exhibit extreme pathogen infestation or infection. Or tree is dead.
- Poor - Tree displays some dieback. Branches or canopy is sparse with little or no signs of new growth or vigour. Possible pathogen infestation or infection. Foliar canopy is sparse.
- Fair - Tree is developing in a manner typical to others in the area. Canopy is full.
- Good - New growth is vigorous as evidenced by stem elongation and colour. Canopy is dense.

Very Good - In addition to the attributes of a good rating, tree is displaying extremely vigorous growth and trunk displays a pattern of vigour cracks or lines.

The following 5 level assessment for structural condition was as follows:

- Very Poor - Trunk has large pockets of decay, is bifurcated or has a severe lean. Limbs or branches are poorly attached or dead. Possible hazard.
- Poor - Limbs or branches are poorly attached or developed. Canopy is not symmetrical. Trunk has a lean.
- Fair - Trunk, limb and branch development though flawed is typical of this species.
- Good - Trunk is well developed with well attached limbs and branches; some flaws but are hardly visible.
- Very Good - In addition to attributes of a good rating, the tree exhibits a well developed root flare and a balanced canopy.

Factors Assessed were as follows:

<b>Roots</b>	<b>Trunk</b>	<b>Foliage/Buds</b>	<b>Scaffold Branches</b>	<b>Small Branches/Twigs</b>
<ul style="list-style-type: none"> <li>· Collar/flare</li> <li>· Mechanical injury</li> <li>· Girdling roots</li> <li>· Insects/disease</li> <li>· Decay/fungi</li> </ul>	<ul style="list-style-type: none"> <li>· Cavities</li> <li>· Mechanical injury</li> <li>· Cracks</li> <li>· Swollen/sunken areas</li> <li>· Insects/disease</li> <li>· Fungi</li> </ul>	<ul style="list-style-type: none"> <li>· Size of foliage/buds</li> <li>· Foliage colour</li> <li>· Foliage injury</li> <li>· Dieback of buds/foilage</li> <li>· Insects/disease</li> </ul>	<ul style="list-style-type: none"> <li>· Attachments/included bark</li> <li>· Taper</li> <li>· Distribution</li> <li>· Decay/cavities</li> <li>· Deadwood</li> <li>· Insects/disease</li> </ul>	<ul style="list-style-type: none"> <li>· Vigour/growth rates</li> <li>· Distribution</li> <li>· Appearance</li> <li>· Insects/disease</li> <li>· Dieback</li> </ul>

### **3.0 Tree Inventory**

A total of 101 trees were inventoried and included in this report. (See Tree Inventory Spreadsheet in appendix 1).

#### **3.1 Trees to Preserve**

The trees in this section have been evaluated suitable for preservation and fall under the Tree Preservation, Protection and Management guidelines in this report. Different approaches of Tree Preservation can be carried out following tree health and structure evaluation. The following describes

the differences in approaches to Tree Preservation.

**1. Preserve, Protect & Maintain**

Includes protection with tree preservation hoarding, as well as pre and post-construction arboricultural works that may include root sensitive excavation.

**2. Preserve & Protect**

Includes the installation of tree protection hoarding; no maintenance will be required unless specified in the recommendations in Appendix 1

**3. Retain**

No protection or maintenance measures are required. Installation of tree protection barriers is optional.

# of Trees evaluated as suitable for Preservation	38
# of Trees to use Method 1	n/a
# of Trees to use Method 2	38 ( #279-#286, #292-#300, #305, #306, #334-#343, #346, #352-#354, #359-#363)
# of Trees to use Method 3	

In the case of 1 Rosetta Street, 38 trees can be preserved on site.

*3.2 Trees to Remove*

All trees scheduled for removal shall be removed prior to any construction, earthworks or installation of tree protection hoarding. Due to site or development, tree condition or location, retention is not warranted. 1 tree is to be removed that requires a permit.

Total of number of Trees to Remove requiring a permit	63
Trees Proposed to be Removed	63 (#263-#278, #287-#291, #301-#304, #307-#333, #344, #345, #347-#351, #355-#358.

### 3.3 *Trees to Injure*

There are no trees scheduled to be injured.

Total of number of Trees to Injure requiring a permit	0
---	---

### 3.4 *Trees to Replant (Replacement)*

Tree replacement ratio requirements are yet to be determined. Species and location is yet to be determined.

### 3.5 *Pruning*

No pruning is required for the proposed site plan.

## 4.0 ***Tree Preservation, Protection and Management***

### 4.1 *Tree Protection*

All trees required to be preserved must be protected with Tree Protection Fencing and be maintained throughout the construction process. Refer to Protection Plan Drawing TP-1 in appendix 3.

### 4.2 *Tree Protection Barriers*

There are 38 trees that are abutting the road extension that will require tree protection barriers. Build tree protection barriers as directed by Town of Halton Hills staff and maintain protection barriers for duration of construction.

**5.0 Conclusions and Recommendations**

Based on all data collected from on-site field work and review of all site plans the following conclusions and recommendations are made and correspond with Tree Inventory in Appendix 1:

Conclusions	Recommendations
63 trees are proposed to be removed that requires a permit to remove.	Apply to remove 63 trees on the subject property.
38 trees that are abutting the road extension will require tree protection barriers	Install tree protection barriers as directed by Town of Halton Hills

Attachments are as follows:

- Appendix 1 Tree Inventory
- Appendix 2 Site Plan / Tree Inventory Plan Drawing TP-1
- Appendix 3 Photographs

This 7 page Report was written by

**Robert Rafal Lis**  
**The Urban Arborist Inc.**  
**ISA Certified Arborist No. ON-1374A**  
**MTCU Qualified Arborist 18004025**



**Tree Inventory (PART 2) – St. Michaels Road Extension – 1 Rosetta Street, Georgetown, ON L7G 3P1 August 8 2024.**

Tag #	Common Name	Botanical Name	Diameter at Breast Height (cm)				Crown Radius (m)	Health Condition	Structural Condition	Notes	Recommendations Based on Site Plan	Proposed TPZ (m)	Replacement Ratio			
263	Black Locust	Robinia pseudoacacia	50	x	50			7	Good/Fair	Fair	2 separate stems	Remove	-	TBD		
264	Black Locust	Robinia pseudoacacia	35	x	37	x	25		5	Good/Fair	Fair		Remove	-	TBD	
265	Black Locust	Robinia pseudoacacia	40	x	39				6	Good/Fair	Fair	Co-dominant	Remove	-	TBD	
266	Black Locust	Robinia pseudoacacia	40						6	Good/Fair	Fair		Remove	-	TBD	
267	Black Locust	Robinia pseudoacacia	46	x	40	x	40		7	Good/Fair	Fair	Co-dominant	Remove	-	TBD	
268	Black Locust	Robinia pseudoacacia	48	x	30				7	Good/Fair	Fair	Co-dominant	Remove	-	TBD	
269	Black Locust	Robinia pseudoacacia	15						4	Fair	Fair/Poor	Leaning heavy west	Remove	-	TBD	
270	Black Locust	Robinia pseudoacacia	26						5	Fair	Fair		Remove	-	TBD	
271	Black Walnut	Juglans nigra	50						8	Good	Good		Remove	-	TBD	
272	Black Walnut	Juglans nigra	27						6	Good	Good		Remove	-	TBD	
273	Black Walnut	Juglans nigra	14						3	Good	Fair		Remove	-	TBD	
274	Black Walnut	Juglans nigra	16	x	15				4	Fair	Fair	irregular growth	Remove	-	TBD	
275	Black Locust	Robinia pseudoacacia	19						4	Fair	Fair		Remove	-	TBD	
276	Black Locust	Robinia pseudoacacia	20						4	Fair	Fair		Remove	-	TBD	
277	Black Locust	Robinia pseudoacacia	10						3	Fair	Fair		Remove	-	TBD	
278	Siberian Elm	Ulmus pumila	10	x	6				3	Fair	Fair		Remove	-	TBD	
279	Norway Spruce	Picea abies	22						3	Good	Good		Preserve & Protect	TBD	-	
280	Sugar Maple	Acer saccharum	20						4	Good	Good		Preserve & Protect	TBD	-	
281	Manitoba Maple	Acer negundo	16						3	Fair	Fair		Preserve & Protect	TBD	-	
282	Black Locust	Robinia pseudoacacia	16						3	Fair	Fair		Preserve & Protect	TBD	-	
283	Black Walnut	Juglans nigra	9						2	Fair	Fair		Preserve & Protect	TBD	-	
284	Black Walnut	Juglans nigra	40						6	Good	Good		Preserve & Protect	TBD	-	
285	Black Walnut	Juglans nigra	28						5	Fair	Fair		Preserve & Protect	TBD	-	
286	Manitoba Maple	Acer negundo	50						7	Good	Good		Preserve & Protect	TBD	-	
287	Norway Maple	Acer platanoides	20	x	18	x	10		4	Fair	Fair		Remove	-	-	
288	Norway Maple	Acer platanoides	20	x	20	x	20		5	Fair	Poor	One stem dead, co-dominant	Remove	-	-	
289	Norway Maple	Acer platanoides	25						5	Fair	Fair		Remove	-	TBD	
290	Trembling Aspen	Populus tremuloides	10						2	Good/Fair	Good/Fair		Remove	-	TBD	
291	Trembling Aspen	Populus tremuloides	15						2	Fair	Fair/Poor	Leaning heavy west	Remove	-	TBD	
292	Trembling Aspen	Populus tremuloides	15	x	15				3	Fair	Fair		Preserve & Protect	TBD	-	
293	Black Locust	Robinia pseudoacacia	65						8	Fair	Fair		Preserve & Protect	TBD	-	
294	Black Locust	Robinia pseudoacacia	48						6	Fair	Fair		Preserve & Protect	TBD	-	
295	Black Locust	Robinia pseudoacacia	65						8	Fair	Fair		Preserve & Protect	TBD	-	
296	Manitoba Maple	Acer negundo	13						3	Good	Good		Preserve & Protect	TBD	-	
297	American Elm	Ulmus americana	13						3	Good	Good		Preserve & Protect	TBD	-	
298	Black Walnut	Juglans nigra	8						2	Good	Good		Preserve & Protect	TBD	-	
299	Trembling Aspen	Populus tremuloides	12						2	Good	Good		Preserve & Protect	TBD	-	
300	Trembling Aspen	Populus tremuloides	10						2	Good	Good		Preserve & Protect	TBD	-	
301	Trembling Aspen	Populus tremuloides	30						4	Good	Good		Remove	-	TBD	
302	Common Apple	Malus sp.	15						3	Good	Good		Remove	-	TBD	
303	Trembling Aspen	Populus tremuloides	40						4	Good	Fair		Remove	-	TBD	
304	Trembling Aspen	Populus tremuloides	41						4	Good	Good		Remove	-	TBD	
305	Black Walnut	Juglans nigra	13						3	Good	Good		Preserve & Protect	TBD	-	
306	Black Walnut	Juglans nigra	11						2	Good	Good		Preserve & Protect	TBD	-	
307	Sugar Maple	Acer saccharum	22						3	Good	Good		Remove	-	TBD	
308	Black Walnut	Juglans nigra	36						5	Good	Good		Remove	-	TBD	
309	Trembling Aspen	Populus tremuloides	16						2	Fair	Poor		Remove	-	TBD	
310	American Elm	Ulmus americana	27	x	14	x	12	x	13	4	Good	Fair		Remove	-	-
311	Sugar Maple	Acer saccharum	12						2	Good	Good		Remove	-	-	
312	Eastern White Cedar	Thuja occidentalis	10	x	10				2	Poor	Poor		Remove	-	-	
313	Eastern White Cedar	Thuja occidentalis	20						3	Poor	Poor		Remove	-	-	
314	Norway Maple	Acer platanoides	15						3	Fair	Fair		Remove	-	-	
315	Eastern White Cedar	Thuja occidentalis	25	x	15	x	8		2	Poor	Poor	Significant deadwood throughout entire tree	Remove	-	-	
316	Eastern White Cedar	Thuja occidentalis	18	x	15	x	8		2	Poor	Poor	Significant deadwood throughout entire tree	Remove	-	-	

Tree Inventory St. Michaels Street Extension

317	Eastern White Cedar	Thuja occidentalis	18	x	16					2	Poor	Poor	Significant deadwood throughout entire tree	Remove	-	-
318	Eastern White Cedar	Thuja occidentalis	15	x	14					2	Poor	Poor	Significant deadwood throughout entire tree	Remove	-	-
319	Eastern White Cedar	Thuja occidentalis	13	x	13	x	10	x	10	2	Poor	Poor	Significant deadwood throughout entire tree	Remove	-	-
320	Eastern White Cedar	Thuja occidentalis	15	x	12	x	11			2	Poor	Poor	Significant deadwood throughout entire tree	Remove	-	-
321	Eastern White Cedar	Thuja occidentalis	15							2	Poor	Poor	Significant deadwood throughout entire tree	Remove	-	-
322	Eastern White Cedar	Thuja occidentalis	15	x	12					2	Poor	Poor	Significant deadwood throughout entire tree	Remove	-	-
323	Eastern White Cedar	Thuja occidentalis	12	x	13	x	9			2	Poor	Poor	Significant deadwood throughout entire tree	Remove	-	-
324	Eastern White Cedar	Thuja occidentalis	13	x	11					2	Poor	Poor	Significant deadwood throughout entire tree	Remove	-	-
325	Eastern White Cedar	Thuja occidentalis	13	x	14					2	Poor	Poor	Significant deadwood throughout entire tree	Remove	-	-
326	Eastern White Cedar	Thuja occidentalis	26							3	Poor	Poor	Significant deadwood throughout entire tree	Remove	-	-
327	Eastern White Cedar	Thuja occidentalis	12							2	Poor	Poor	Significant deadwood throughout entire tree	Remove	-	-
328	Sugar Maple	Acer saccharum	30							4	Good	Good		Remove	-	-
329	Trembling Aspen	Populus tremuloides	20							3	Fair/Poor	Fair/Poor	Leaning, some deadwood	Remove	-	TBD
330	Trembling Aspen	Populus tremuloides	13							2	Good	Fair/Good		Remove	-	TBD
331	Trembling Aspen	Populus tremuloides	13							2	Good	Fair/Good		Remove	-	TBD
332	Trembling Aspen	Populus tremuloides	17							3	Good	Fair/Good		Remove	-	TBD
333	Trembling Aspen	Populus tremuloides	10							2	Poor	Poor	Surrounded by smaller	Remove	-	TBD
334	Trembling Aspen	Populus tremuloides	10							2	Poor	Poor	Surrounded by smaller	Preserve & Protect	TBD	-
335	Trembling Aspen	Populus tremuloides	12							2	Poor	Poor	Surrounded by smaller	Preserve & Protect	TBD	-
336	Trembling Aspen	Populus tremuloides	13							2	Fair	Fair	Surrounded by smaller	Preserve & Protect	TBD	-
337	Trembling Aspen	Populus tremuloides	20							3	Fair	Fair	Surrounded by smaller	Preserve & Protect	TBD	-
338	Trembling Aspen	Populus tremuloides	11							2	Good	Good	Surrounded by smaller	Preserve & Protect	TBD	-
339	Trembling Aspen	Populus tremuloides	16							3	Fair	Fair	Surrounded by smaller	Preserve & Protect	TBD	-
340	Trembling Aspen	Populus tremuloides	17							3	Fair	Fair	Surrounded by smaller	Preserve & Protect	TBD	-
341	Trembling Aspen	Populus tremuloides	12							2	Fair	Fair	Surrounded by smaller	Preserve & Protect	TBD	-
342	Sugar Maple	Acer saccharum	20							3	Good	Good		Preserve & Protect	TBD	-
343	Norway Maple	Acer platanoides	23	x	22	x	18			4	Fair	Fair		Preserve & Protect	TBD	-
344	Sugar Maple	Acer saccharum	23							3	Good	Good		Remove		TBD
345	Black Walnut	Juglans nigra	16							3	Good	Good		Remove		TBD
346	Manitoba Maple	Acer negundo	27							4	Good	Good		Preserve & Protect	TBD	-
347	Sugar Maple	Acer saccharum	28							3	Dead	Dead		Remove		TBD
348	Norway Maple	Acer platanoides	22							4	Fair	Fair	leaning west	Remove		TBD
349	Norway Maple	Acer platanoides	24							4	Good	Good		Remove		TBD
350	Sugar Maple	Acer saccharum	15							3	Good	Good		Remove		TBD
351	Sugar Maple	Acer saccharum	12							2	Good	Good		Remove		TBD
352	Manitoba Maple	Acer negundo	35	x	35					4	Very Poor	Very Poor	Failed stems, decay, dying	Preserve & Protect	TBD	-
353	Sugar Maple	Acer saccharum	27							4	Good	Good		Preserve & Protect	TBD	-
354	Manitoba Maple	Acer negundo	18							3	Fair	Fair		Preserve & Protect	TBD	-
355	Black Walnut	Juglans nigra	16							3	Good	Good		Remove		TBD
356	Sugar Maple	Acer saccharum	12							3	Good	Good		Remove		TBD
357	Sugar Maple	Acer saccharum	16							3	Good	Good		Remove		TBD
358	Sugar Maple	Acer saccharum	29							4	Good	Good		Remove		TBD
359	Sugar Maple	Acer saccharum	25							4	Good	Good		Preserve & Protect	TBD	-
360	Norway Maple	Acer platanoides	3							1	Good	Good	Surrounded by smaller	Preserve & Protect	TBD	-
361	Manitoba Maple	Acer negundo	3							1	Good	Good		Preserve & Protect	TBD	-
362	Apple	Malus sp.	8	x	7	x	5			2	Good	Good		Preserve & Protect	TBD	-
363	Siberian Elm	Ulmus pumila	10	x	9	x	10			2	Good	Good		Preserve & Protect	TBD	-

ARBORIST REPORT PART 2  
ST. MICHAEL'S ROAD EXTENSION

ARBORIST REPORT PART 1  
ST. MICHAEL'S ROAD  
ALSO SEE PREVIOUSLY COMPLETED REPORT DATED MARCH 11 2021

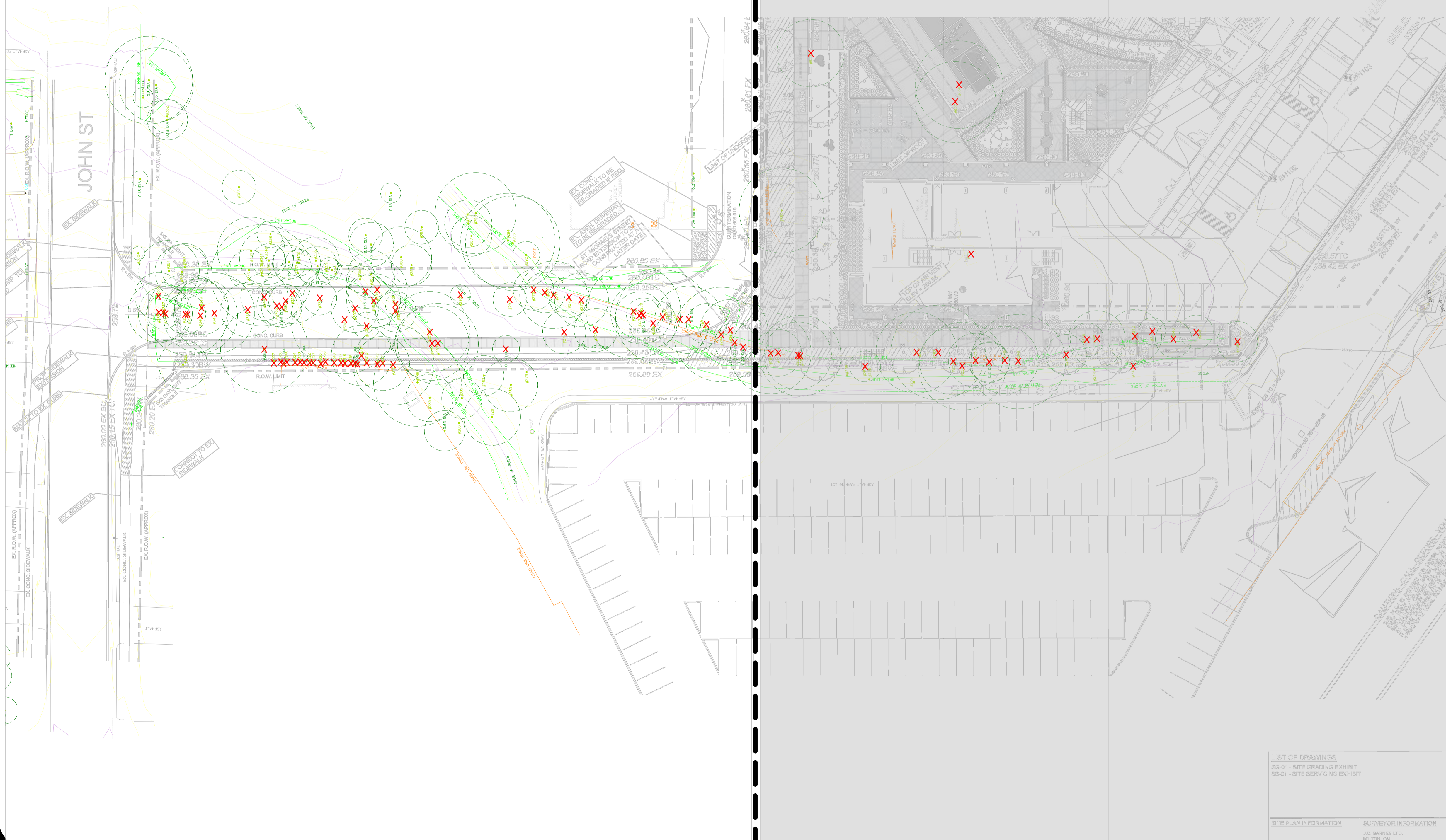
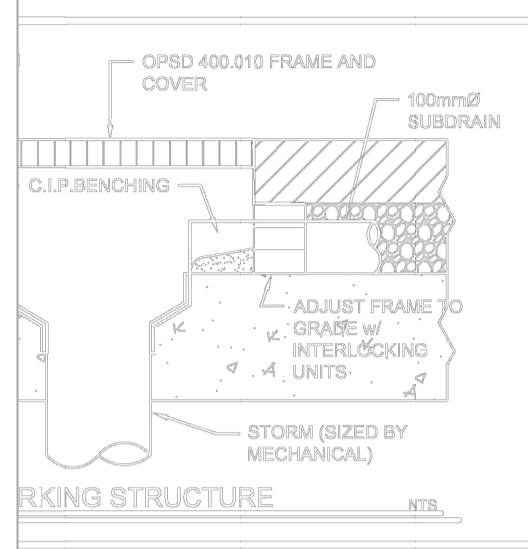

General Notes

- EXISTING TREE
- ✕ TREE TO REMOVE
- LIMIT OF CANOPY
- TREE PROTECTION BARRIER
- ⊗ REPLACEMENT TREE TO PLANT



Robert R Lis  
ISA Certified Arborist  
NO. ON-1374A

No.	Revision/Issue	Date

Firm Name and Address  
The Urban Arborist Inc.  
P.O. Box 74525  
Humbertown Centre  
Etobicoke, ON  
M9A 5E2

Project Name and Address  
1 Rosetta Street  
Georgetown, ON.  
L7G 3P1

Project	Tree Inventory Plan	Sheet	TP-2
Date	30.09.2024		
Scale	As Noted		

LIST OF DRAWINGS  
89-01 - SITE GRADING EXHIBIT  
89-01 - SITE SERVICING EXHIBIT

SITE PLAN INFORMATION      SURVEYOR INFORMATION  
J.D. BARNES LTD.  
MILTON, ON